

HEAT EXCHANGER TUBE INSERTS



TUBE TOOLS



SHINGARE

INDUSTRIES PVT LTD

MANUFACTURER & EXPORTER OF

Tube Cleaners, Tube Tools,
Tube Expanders, Bolting Tools, Impact Sockets,
Pipe Beveling Machines, Pipe Cold Cutting Machines,
High Pressure Water Jet Cleaning Machines & Tapping Machines

INSERTS FOR TUBE END PROTECTION: HEAT EXCHANGER TUBE AND METAL INSERTS

HEAT EXCHANGER TUBE INSERTS

SHINGARE make Nylon Tube inserts are popularly used in industry to provide protection for tube ends of heat exchangers mainly (Shell and Tube type heat exchanger). The End of shell and tube type heat exchanger is mainly subject to erosion, corrosion, and impingement. Such corrosion is quick and substantial in marine industries due to use of salt water.

The Main Troubles Taking Place In Shell & Tube Heat Exchanger Are Briefly Described Below:

- Thermal wear and corrosion of tube ends
- Cracking due to induced thermal Stress
- Crevice Corrosion in confined & non accessible parts such as cracks and seams.
- Pitting or Creation of small holes on tube surface
- Grooving caused due to Ammonia
- Inappropriate Tube expansion
- Weakened Tube to tube sheet joints.



SHINGARE Industries Pvt Ltd has emerged out with the most effective solution for all the above troubles. We have introduced most cost-effective tube repair solution and that is known as **SHINGARE** make Tube Inserts. Also known as Ferrules or tube end Shield/Seal or Tube End Protector

Material of construction (moc)

Heat Exchanger Tube Inserts: Nylon (Polyamide), LDPE (Low-density polyethylene)

Shingare Industries Pvt Ltd provide two types of insert head design. These are as follows:

- **BONNET TYPE** : Generally Tubes are projected for about 3 mm to 5 mm outside the Tube Sheet of Heat exchanger. Bonnet head is used to cover such ends. This encapsulates the projection in such a way that the high velocity impingement has no effect on the tube mouth end. And provides longevity of tube mouth end.
- **FLARED HEAD** : When Tubes are not projected outside Flared head inserts are used.

Material Selection:

- Heat Exchanger Tube Inserts : Suitable for Surface Condensers (Low temp range)
- Nylon Tube Inserts : Suitable for temperature up to 150 degree Celsius.
- PTFE Tube Inserts : Suitable for temperature up to 250 degree Celsius.

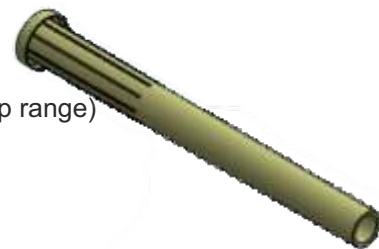

Tube Inserts prevent tube end erosion and costly retubing of Condensers and Heat Exchangers. **Heat Exchanger Tube Inserts** offer permanent protection for new tubes or extended life for old tubes already pitted or thinned at the insert section.

HEAT EXCHANGER TUBE INSERTS

Some sizes also available in 4" lengths. Inquire about additional sizes.

Part Number	Tube O.D	Tube Gauge	Tube Wall Thickness	Tube I.D	Insert Length
STIN-58186	5/8"	18	0.049	0.527	6"
STIN-58206	5/8"	20	0.035	0.555	6"
STIN-34166	3/4"	16	0.065	0.620	6"
STIN-34186	3/4"	18	0.049	0.652	6"
STIN-78166	7/8"	16	0.065	0.745	6"
STIN-78186	7/8"	18	0.049	0.777	6"
STIN-78196	7/8"	19	0.042	0.8	6"
STIN-1166	1"	16	0.065	0.870	6"
STIN-1186	1"	18	0.049	0.902	6"
STIN-1206	1"	20	0.035	0.930	6"

METAL TUBE INSERTS

In order to provide protection to the tube mouth ends of shell and tube heat exchanger tube inserts are used. These tube inserts are generally in the form of metal, plastic or polymer. As the name suggests tube inserts are inserted into ends of tubes thus provides protection to the ends. maintaining is always cheaper then replacing. Since it ensures cost saving as well as time saving. All tube failures happen at the few inches from tube inlet end. As a solution we can use thin wall covering in form of metal tube inserts which expands full length into the inlet end of condensers and heat exchanger. Bhartiya make heat exchanger tube inserts are specially designed make sure a smooth and gentle transition of the fluid down the tube inserts to the condenser or heat exchanger tube, We have below ferrous and non ferrous tube inserts.



METAL TUBE INSERTS

FERROUS : Inconel alloy inserts are typically used of high temperature applications. They are wrapped with ceramic paper. In this one end of insert is flared and the other end is a reverse tapered to hold the ceramic fiber properly.



NON FERROUS : Non Ferrous inserts are used in application with very high temperature such as 900 degree Celsius. It is suitable when such high temperature present on tube side of the heat exchanger. At this temperature tube sheet can't be wrap, instead of this we can use tube inserts. The tube insert has an hour glass form. This creates an air gap between the tube insert and the parent tube. This gap can be wrapped with high temperature 1260 degree Celsius ceramic paper. The paper is taped in place. We recommend tape full length. There are two advantages for full length tape, one, more high temperature ceramic paper can be compressed on to the tube insert, two, the tape protects the ceramic paper which cannot withstand even minor abuse. Some tube inserts have anchors that become imbedded into the refractory others have pins with ceramic paper to set the tube insert at a specific height from the tube sheet.



OUR MAJOR CLIENTS

Please see below our robust and valued client list that uses BHARTIYA products repeatedly. We take pride in our partnerships and the ability to grow with such amazing group of companies.



SHINGARE™
INDUSTRIES PVT LTD

SHINGARE INDUSTRIES PVT. LTD.

Formerly known as Bharatiya Industries

- ✿ Manufacturer & Exporter of Tube Cleaners, Flexible Shafts, Tube Tools, Impact Sockets, Bolting Tools, Pipe Cold Cutting and Beveling Machines, Torque Tools, Grinding Tools, Tapping Tools, Hydraulic Torque Wrench, Electric Torque Wrench, Manual Torque Wrench & Torque Multiplier
- 📍 **Factory Add:** A-48 B Osiya Mataji Compound, Village Kalher, Retibunder Road, Tal. Bhiwandi, Dist. Thane - 421302, Maharashtra.
- 📍 **Hade Off:** B-227, 2nd Floor, Eastern Business District (Magnet/Neptune Mall), L.B.S. Marg, Bhandup (west), Mumbai - 40078.
- ☎ +91 77188 96512 | + 91 90290 05461 ✉ bharatflex@yahoo.com | spradip@tubecleaner.co.in
- 🌐 www.shingare.com | www.tubecleaner.co.in